

S600 SERIES



Quick Start Harvest Guide

FAROL 

Contents

Quick Start Videos	03
Combine Checklist	04-06
Header Guide	07-08
Technology Guide	09
Command Arm	10
Corner Post Display	11
Hillmaster	12
Crop Change & Documentation	13-15
Calibrations	16-18
Performance Principles	19
Harvest Smart	20-25
Multi-function Lever	26
Operation ICA	27-35
MyOperations App	36-37
JDLink	38
Go Harvest Mobile	39-42
Offsets	43
Cleaning Guide	44-45



Quick Start Videos

For quick start videos, scan the QR code below, or go to -
<https://www.youtube.com/playlist?list=PLtw5x6F2At4s6BtkGjxLDzPSuNahV27J>

I-Phone users – Just hold your camera up to it and click the link

Android users – Hold your camera up to it and select the barcode option



Machine Videos



Display Video



Header Videos

My Operations App



With the John Deere My Operations app it allows quick and easy access to machine location, harvest settings, remote display access and with a connect subscription can quickly provide yield, moisture and speed maps. This will bring up fields and machines with quick access via the search facilities.

download in the app store – John Deere My Operations

Combine Checklist

With any new machine, chains and belts can take a few days to bed in, so please keep an eye on all chains and belts, and adjust if necessary. There are a few pointers below to keep on top of ensuring the best experience with your new machine.

Feeder House



Feeder House elevator chains, it's perfectly normal for the feeder house chain to work loose after some initial work of the machine, but it's important to keep this adjusted correctly, we are looking to have the first elevator slat in the fully forward position, as per the slat on the left hand side of the photo, we then want to count this as slat no.1 and count back to the 4th slat on that side, should just be touching the bottom of the feeder house, please adjust accordingly

Returns and clean grain elevators

Grain elevator chains will stretch as they bed in and it's important to keep these correctly tensioned, for chain life and grain quality. It is a very quick and easy check, if you open up the covers to access the chain, you will be looking to be able to have some side to side movement on the lower sprocket. If you have some slack in the chain and can feel a gap this is too much slack, if you can't move the chain side to side on the sprocket this is too tight. *Check these are closed and secured after winter storage, S- Series machines also have an extra inspection cover on the active returns.(please see lower picture)*



General Chain and belt tension

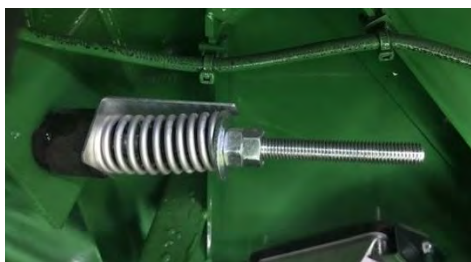

John Deere combines all have a series of belt and chain tensioner alignment tools; it's a very quick and easy visual check. It's very important to have belts and chains tensioned correctly to prevent slippage and achieve the maximum life out of the components. If you make sure the indicator is in line with the washer on the spring, that is perfect, if not please adjust as necessary

Operator Tip: NEW machines, pay attention to unloading auger chain and chopper belt tension

Greasing – please follow the grease charts on the machine, Hillmaster machines need the
Pivots greasing daily !!

Grain Tank Drain Covers



Before going in to crop please ensure that all the grain tank drain covers have been put back in the work position. There are two covers either side of the unloading auger drive as per picture on the left. There are also two covers on the opposite side as per picture on the right.



Grain conveyor augers



To aid the cleaning process on the combine there is the facility to open up the front of grain conveyor augers, please check this is closed before harvesting.

S - series design on the left with a handle
T - series design on the right with 2 wing nuts securing.



Header

With John Deere headers, there are a few basic settings we recommend as shown on the right; sometimes you may need to come away from these

- Rape seed raise the auger from the standard position if you find crop stalling in the centre of the header, make the auger finger timing more aggressive if you are still struggling.
- Linseed – if you are experiencing wrapping around the feed auger, remove all retractable fingers except one in the centre.

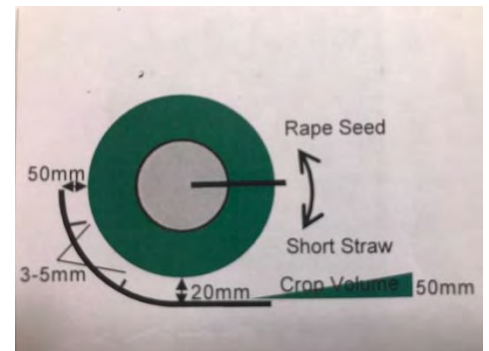

Operator tip: Incorrect finger timing adjustment can cause premature wear



With the spare knife on the X- headers it comes standard with a knife head only, if you have a spare knife or replace it please note how the spare knife is supported in the picture on the left, if the knife goes in further than this the extending part of the platform can foul it. The spare knife is normally a fine tooth Knife.

After the first few hours of use please check the bolts for the auger finger timing, also after adjusting the auger finger timing please check that these bolts are tight. If they work loose it can cause potential for the auger fingers to contact the bed of the header. Please see pictures of the 2 different designs



Combine Checklist

With any combine that has been cleaned, please be sure to check the following before going to work, as they will have been left open to clean it down correctly.

Returns and clean grain elevators

Check these are closed and secured after winter storage, S- Series machines also have an extra inspection cover on the active returns.



Grain Tank Drain Covers



Before going in to crop please ensure that all the grain tank drain covers have been put back in the work position. There are two covers either side of the unloading auger drive as per picture on the left. There are also two covers on the opposite side as per picture on the right.



Grain conveyor augers



*To aid the cleaning process on the combine there is the facility to open the front of grain conveyor augers, please check this is closed before harvesting. S - series design on the left with a handle
T - series design on the right with 2 wing nuts securing.*



600X Extendable Auger Platform

Settings and Adjustments Quick Reference Guide



JOHN DEERE

Basic Settings

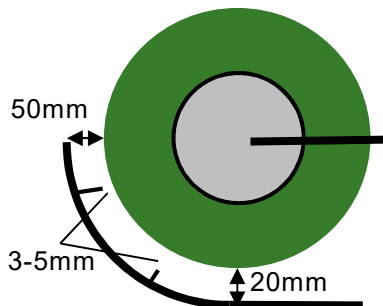

Auger Position

Flights to Rear wall 50mm
Flights to Trough 20mm
Always try to keep auger down, only move up if bunching or stalling occurs.

Auger Strippers

Keep strippers as tight as possible to the auger flights. 3-5mm is recommended.

Auger Fingers

In normal conditions auger fingers are in most extended position when pointing straight forward (3 o'clock).

Reel Position

Reel tube touching the heads and pushing crop over the cutter bar.

Reel Tines

Straight down

Reel Speed

Slightly above ground speed to push plants into platform.

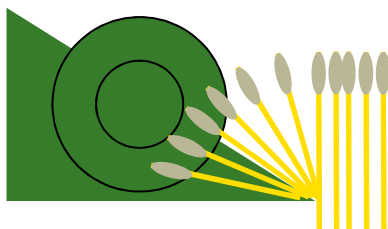
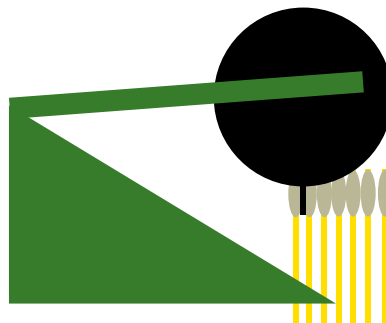

Cutter Bar Position

Chose Cutterbar position according to plant height.
 $\text{Plant Height} - \text{Cut height} = \text{Cutter bar position}$

Or use Wizard in Display

Adjustments

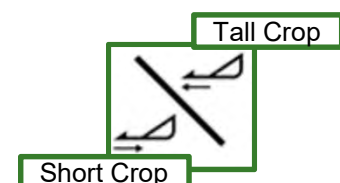
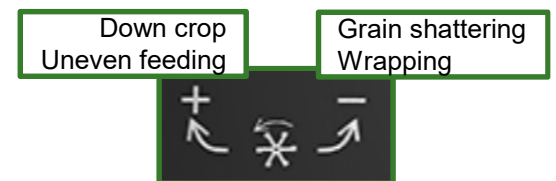
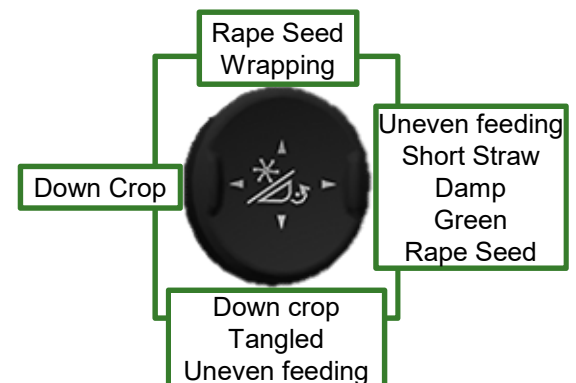
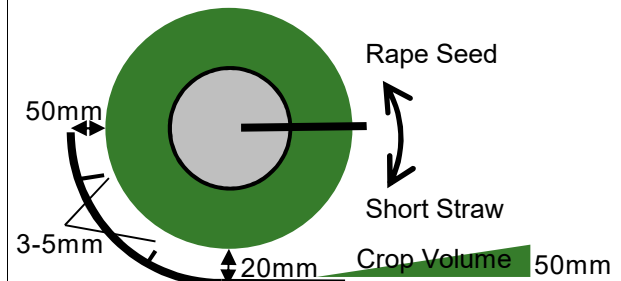

In Short Crops do not retract the Cutter bar shorter than 450mm. Also extend the table first completely and then retract it. Doing this the sealing bridge will be moved all the way forward. This will allow you to have the Reel in a better position to sweep the Cutterbar and move material to the Auger

Move the Reel to the rear position on the Reel arms if more active feeding of the Reel is needed

IMPORTANT: This guide is to assist operators with correct setup and operation of 600X extendable Auger Platform.

Always refer to your Operator's Manual for questions

600X Extendable Auger Platform

Settings and Adjustments Quick Reference Guide



Material stalling in the sides

Auxiliary Reel Tines
BXE11039



Long Rye or Barley bunching on Crop Divider

Additional long deflector
BXE11102



Crop accumulating between knife and auger

Keep table extended at 500mm setting.
Move reel to rear position at the reel sleds.
This allows the reel to operate closer to cutterbar



Reel is not level

Rephase Reel by lowering it completely.
Table must be in rear position, reel fully extended.
Bleeding is not required.

High Yielding Crop and unheterogeneous conditions

Auger Speed up
HXE 76332



Increased speed is not recommended in all conditions

Rape seed stalling in center of header

Adjust finger timing to 4:00

Raise Auger

Remove Speedflights

Use larger reverse flights for 635X and 640X

HXE108653 and HXE108654

For S-Series: change finger configuration to T670 configuration



Check Knife and Guard wear regular

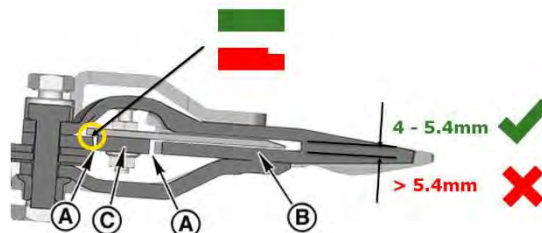

IMPORTANT: This guide is to assist operators with correct setup and operation of 600X extendable Auger Platform.

Always refer to your Operator's Manual for questions

Technology Guide



JOHN DEERE

NOTHING RUNS LIKE A DEERE



QUICK START UP. COMMANDARM™ CONTROLS.

A	Hydrostatic lever
B	Header resume buttons
C	AutoTrac resume switch
D	Emergency stop
E	Unloading auger in/out: on/off
F	Reel and header manual controls
G	Engine speed buttons/gear selection/ differential lock/4WD controls
H	Separator and feederhouse-engage switches HarvestSmart on/off
I	Combine settings, concave distance, drum/fan speeds, cleaning shoe
J	Beacons/radio/air-conditioning controls
K	Dial-a-height and dial- a-speed. HillMaster.
L	CommandCenter/2630 Display



CORNER POST DISPLAY

- A** Isochronous governor power meter
- B** Engine temperature
- C** Fuel/AdBlue levels
- D** Engine rpm & Ground speed
- E** Header resume modes
- F** Returns level
- G** Sieve loss/total loss/separator loss
- H** Header height
- I** Park brake
- J** Gear selection

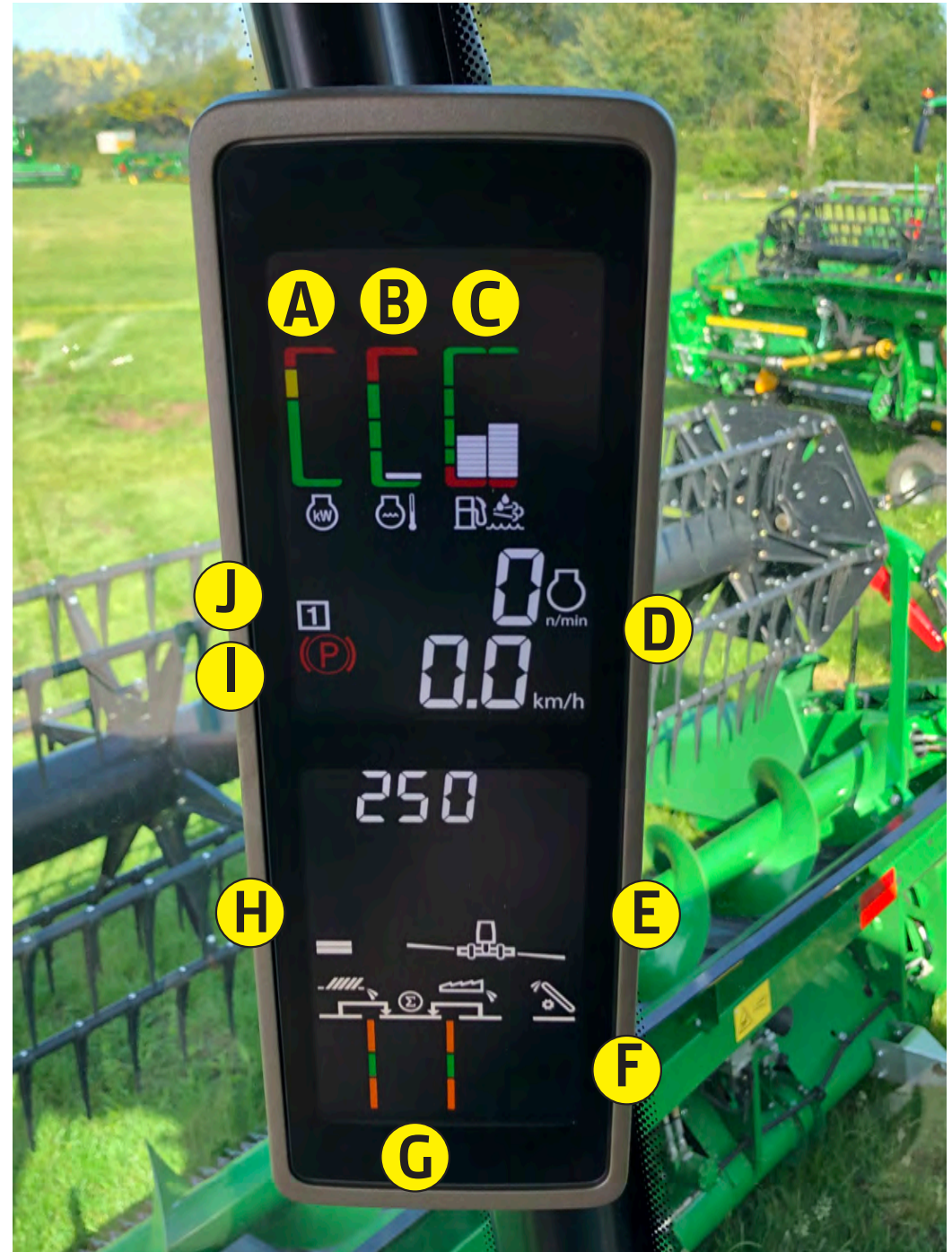

Hillmaster

The hillmaster system has 2 positions road mode and field mode.

Engage field mode – press the button on the right-hand side so the light is illuminated, and release the hand brake. Now manually lean the machine all the way over to one side using either the left hand or right hand tilt buttons, release the manual tilt button. The machine will now level itself to the field position.



Operator tip – ensure hillmaster is in field position whilst harvesting, every time the ignition is cycled, the hillmaster light will automatically switch off, remember to engage whilst harvesting.

Engage Road Mode – Press and hold the button on the right-hand side until it flashes, release the handbrake.

Now manually lean the machine all the way to the left, once it is all the way down on the left, lean it all the way to the right. The machine should now be in the lower position for transport.

Operator tip – ensure hillmaster is in field mode before attaching/removing header.

Hillmaster machines need the **Pivots greasing daily!!**
failure to do so can cause premature wear and uneven stable height.

Video link below

<https://www.youtube.com/watch?v=hy2bQufDfSU>



Combine Crop Change 2630 screen



To change crops, go in to the menu button, bottom right hand side highlighted green.

Go in to the GS3 menu, highlighted green.

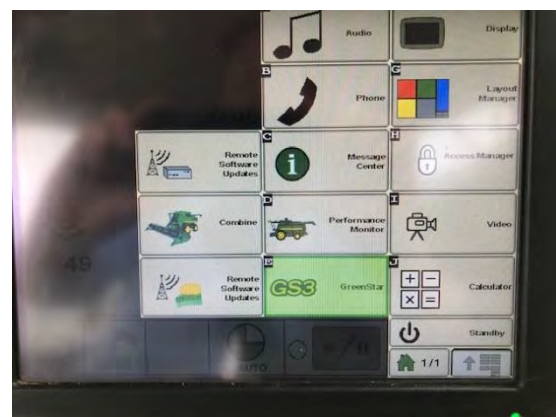

Go in to document, highlighted green

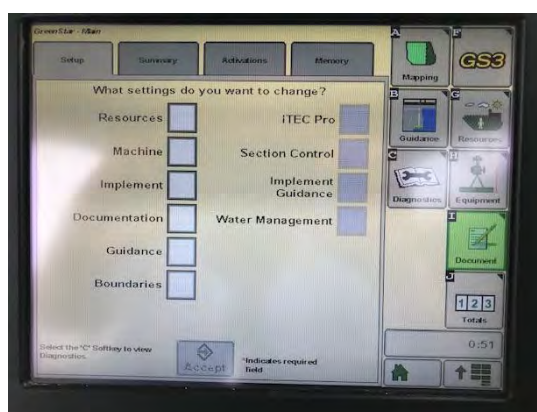

Select change harvest settings, highlighted green.

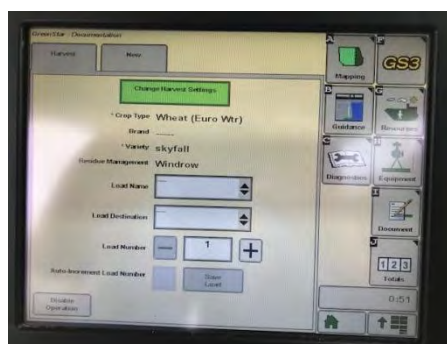

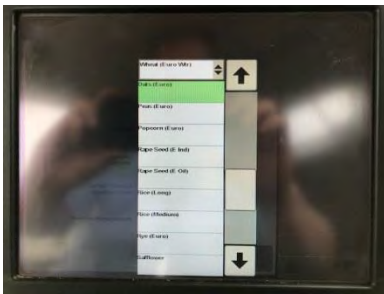

There will be drop down menus for both crop type and variety, these are mandatory so please ensure this are filled in correctly.

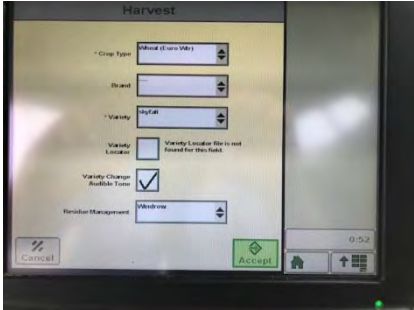
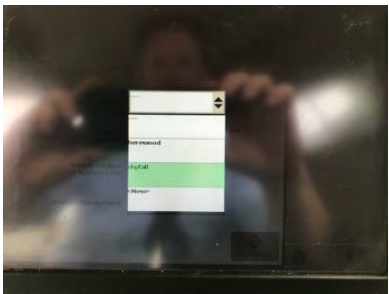

Press accept once all settings are filled in, this will then take you back to the GS3 screen. Once in the GS3 screen press the menu button on the bottom right hand side, highlighted green.



Select the combine icon, highlighted green.

Press the settings icon, highlighted green, arrow with a dot above it.



Once in the settings page, press the separator settings, highlighted green, icon with separator on.

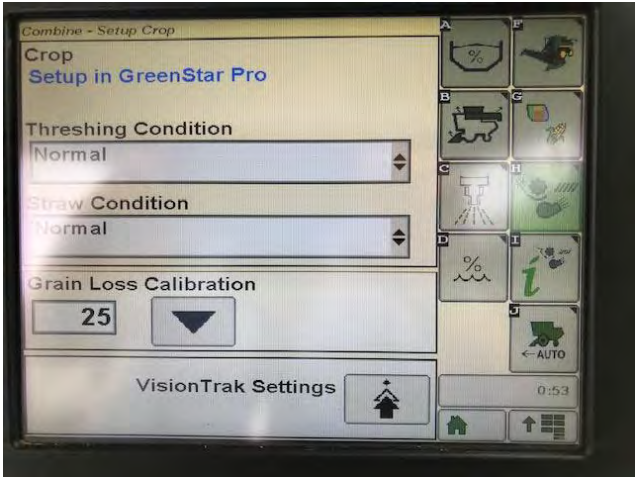

Engage the separator, raise the engine speed to maximum. Press the accept button, this will load up the crop settings accordingly. Note that settings in black are actual and desired settings are highlighted in blue, the settings in black will flash whilst they are changing.



Documentation through the 2630 screen

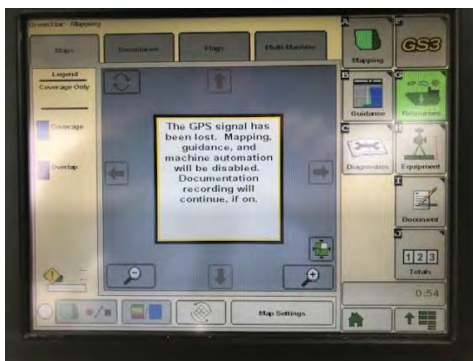

If you wish to document data for different fields, enter the GS3 menu and select the resources button, highlighted green.

There will be drop down menus, please fill in accordingly. This will allocate the harvest data to each client, farm, field accordingly. If you have visited these fields before if you tick the box for field locator, the machine should recognise which fields you are in.

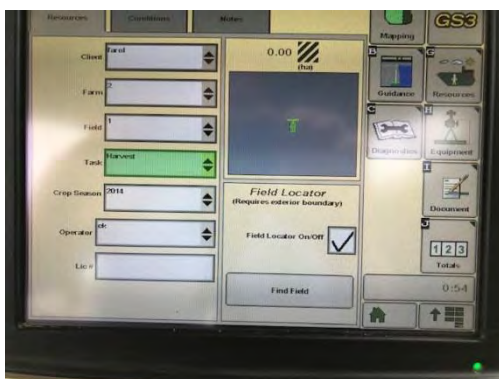
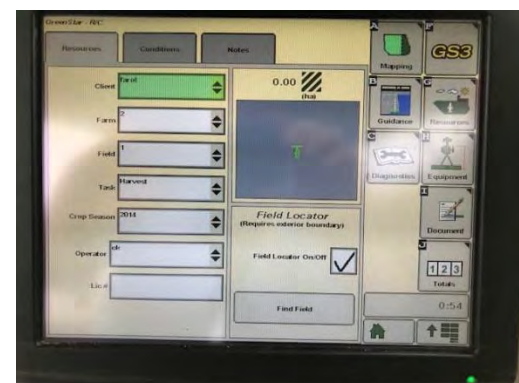

In the Task box please make sure that this is selected as harvest, once this is complete, you can return back to the harvests screen using either the home button or menu button in the bottom right hand corner of the screen.

Grain – Loss calibration

To achieve the maximum out of the machine it is necessary to calibrate the loss monitors your personal acceptance level.



Come in to the combine screen, select the settings menu, arrow with a dot above it, highlighted green.

Once in the setting menu you will have to press the crop settings icon, highlighted green



Drive the machine to an acceptable loss level, press the calibration button, this will calibrate the loss sensors to your acceptable loss level.



Once complete, return back to the main combine menu by pressing the combine button in the top right hand corner, highlighted green.



S-Series Combines

Moisture and Yield System

Moisture sensor is mounted within the Elevator Mount Unit on the side of the clean grain elevator.

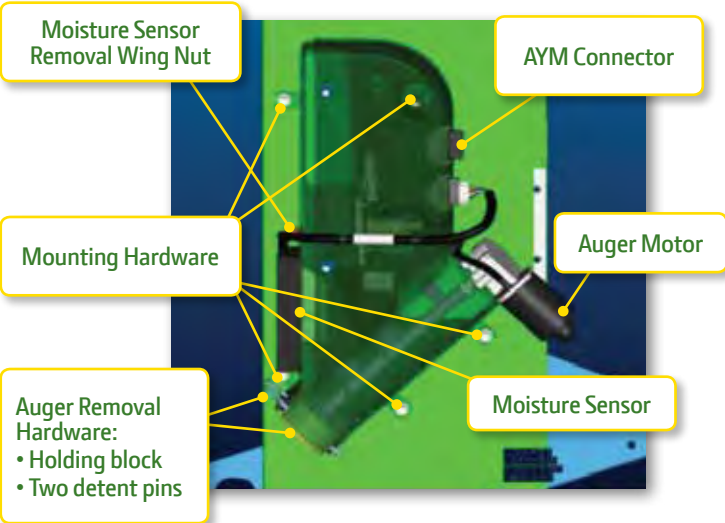

Mass Flow sensor is mounted on the transition housing, inside the grain tank.

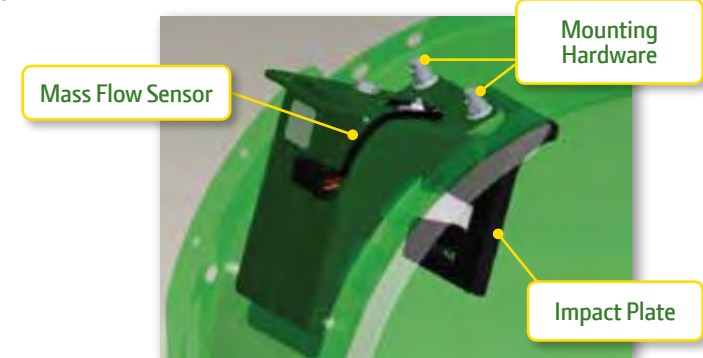

S-Series Combines

Calibration Sequence

- 1 Temperature calibration
- 2 Mass Flow Vibration calibration
- 3 Moisture Correction and calibration
- 4 Weight (yield) calibration



S-Series Combines

1 Temperature Calibration

The reading should be an accurate measurement of the surrounding air temperature. Perform once a season and be sure the moisture meter is empty.

1. From the combine home page press B.



2. Next press G for user calibrations.



3. Select "Moisture Sensor Temperature" from the calibration list and press accept.



Moisture Sensor Temperature

4. Use the "+" or "-" button until the sensor temperature matches the surrounding.

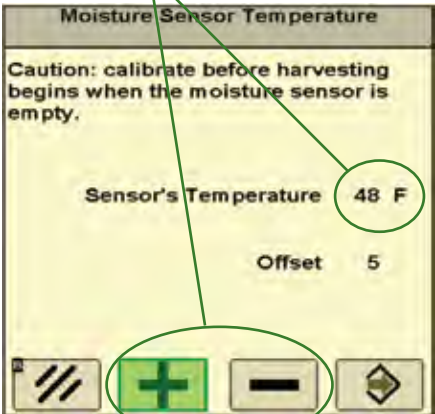

5. Select the accept button when complete.



Yield Calibration Procedure S-Series Combines

2 Mass Flow Vibration Calibration

Select the correct crop type as this calibration will be saved under the crop identified in the combine setup. Perform this calibration with the correct head on the combine in the harvest operating position. Perform in each crop type.

1. From the combine home page press **B**.
2. Next press **G** for user calibrations.
3. Select **"Mass Flow Vibration"** from the calibration list and press **accept**.

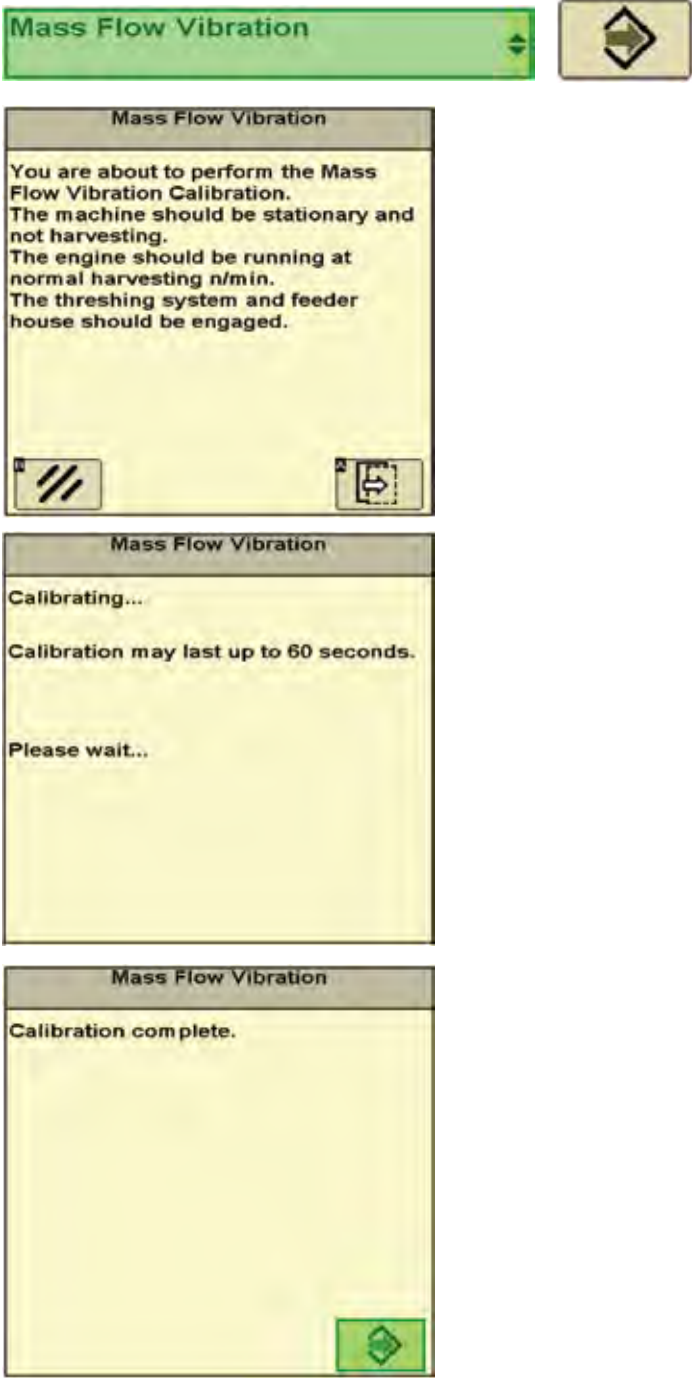

4. Follow the instructions in the calibration. Engage the header and separator, with the header in the harvesting position take the engine speed to high idle, be sure the header is not resting on the ground and the grain tank is empty.

3 Moisture Correction and Calibration

Temperature calibration should be performed before this correction. Ensure moisture sensor metal plates are clean at the beginning of each season. Plates may be cleaned with glass cleaner or water. Calibrate moisture for each grain type.

1. From the combine home page press **H**.
2. Then press **D** for "Moisture Setup".

3. Check mark the box labeled "Moisture Correction".

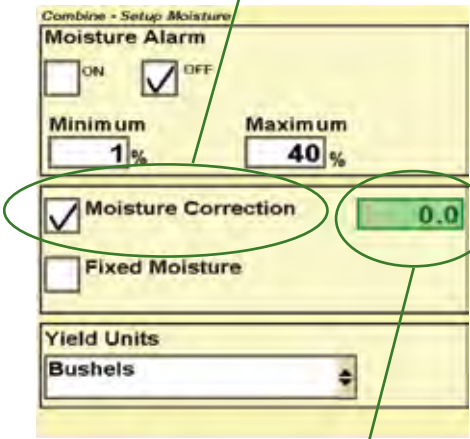

4. Next be sure the numerical box reads **0.0**, if it does not highlight and change. You may return to the combine home page if desired.

5. Harvest a load of grain and note the "Avg. Moisture" on the Harvest Monitor. Example: 13%.
6. Randomly sample the grain from several locations in the grain tank to collect an average moisture sample. Then measure the average moisture of this sample using an accurate/trusted moisture tester. Example: 12%.
7. Return to the "Moisture Setup" page and enter the difference in the "Moisture Correction" numerical box. Example: Moisture tester (12%) minus the Combine displayed "Average Moisture" (13%) equals -1.0.

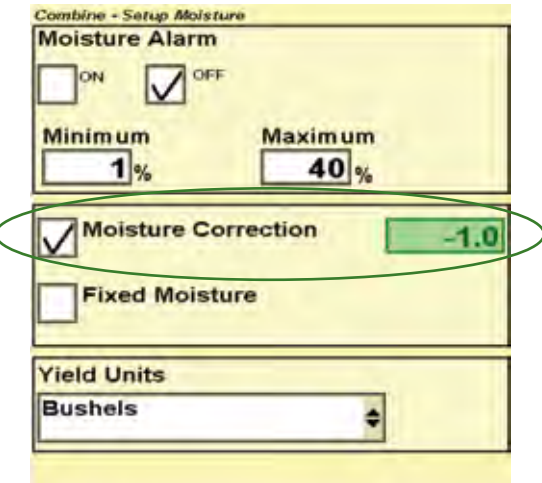

8. Repeat as necessary until satisfied.

If moisture readings become erratic in high moisture grain, clean the moisture sensor with water or glass cleaner to remove build up from the metal (fin shaped) capacitance plates.

Moisture Meter Capacitance Plate



4 Weight (Yield) Calibration

Things to know:

- Perform Temperature and Moisture correction before Weight calibration.
- Calibration loads should be uniform in size and be a minimum of 3,000 lbs.
- A maximum of 13 calibration loads can be saved for each crop type.
- For more accurate results use 4 to 8 calibration loads.
- Harvest each calibration load at a different flow rate (ground speed). Example: 2, 3, 4, or 5 mph.
- Calibrate for each crop type.

Process:

1. From the combine home page press **B**.
2. Next press **G** for user calibrations.
3. Then select **"Yield"** from the list of calibrations and press **"accept"**.



NOTE: This screen will be the first Yield calibration screen if there is no pending calibration.



This screen will allow the following options:

- Manage existing calibration loads
- Start new calibration load
- Cancel the calibration process

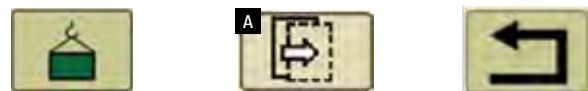

4. Select the **"next"** button to begin the calibration, be sure the grain tank is empty.

5. The display will list the first available load number. Begin to harvest, and unload only after accumulating 3,000 lbs. or more.



6. Unload and record the actual scaled weight. Select the **"next"** button and enter the **"Actual"** scale weight in the numerical box.

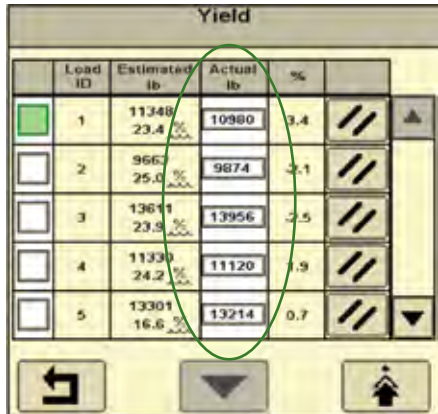

7. Return to the "Yield Calibration" page by pressing the **"return"** icon. Press the **"next"** icon and repeat steps 4 through 7 at different ground speeds.



8. After completing your calibration loads return to the "Calibration Management" screen and check mark the boxes next to the load ID numbers with the **"%"** between the range of -3.0 and 3.0.

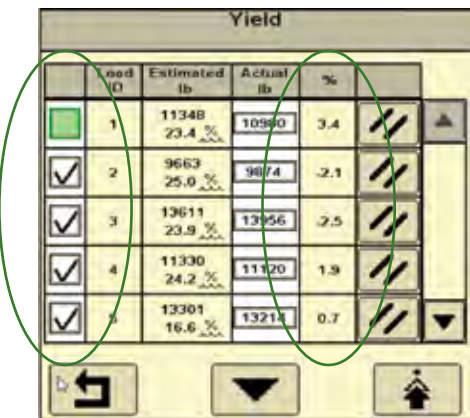

9. Now press the **"Calibration"** icon.



Once the calibration has completed updating press the **"accept"** icon to exit.



10. To delete unwanted calibration loads or make space for new loads press the **"delete"** icon next to the corresponding load ID. This will permanently delete the cal load.



S – Series Performance Principles

Threshing

- Threshing is getting the grain out of the ear, please don't confuse with separation which is getting the grain out of the straw mat.
- Concave clearance is the main factor for more aggressive threshing, to tight on the concave clearance will compromise throughput and consume more horsepower.
- To optimise this setting, keep opening the concave clearance until you see un-threshed heads, then tighten the concave slightly.
- Heavier crops and easier threshing crops will require a wider setting.
- Light crops or hard threshing (Barley) will require a tighter setting.
- Standard rotor position (7 revolutions) will give more aggressive threshing than advanced (5 revolutions)

Separation

- Separation is getting the grain out of the straw mat, heavy grains and a light straw mat creates easy separation, light grains and a heavy/wet/green straw mat creates harder separation.
- As the concept of a rotary machine relies on centrifugal force to spin grain out of the straw mat work with the principle that higher rotor speed creates more separation, although to much rotor speed can comprise straw quality in brittle conditions.
- Once threshing clearance is set, start with a high rotor speed then work down until losses start to increase.
- To much rotor speed may overload the cleaning shoe, excessively damage straw and use excess power.
- Standard rotor position (7 revolutions) will give better separation than advanced (5 revolutions)

Cleaning Shoe

- **Top Sieve** – what doesn't go through the top sieve will travel out the back of the combine-causing shoe loss – could be caused by excess wind speed or to little sieve opening.
What does go through the top sieve will fall on to the bottom sieve
- **Bottom sieve** – what doesn't go through bottom sieve will fall in to returns, what does go through the bottom sieve will go straight to tank, if sample is dirty consider closing the bottom sieve slightly.
- **Wind speed** – to much wind speed will cause excessive shoe loss, to little will cause chaff overloading, if sample is dirty increase wind speed slightly.
- ***Setting up the cleaning shoe is finding a balance between all 3 settings; the combine will measure shoe loss and returns load to help you make cleaning shoe settings.***
- If you find that the machine is becoming shoe limited before threshing or separation, it would be recommended to try the advanced rotor setting as this will reduce any over threshing/separation which may cause excess shoe load.

Please change one setting at a time as the machine will need approx. 20 metres for the new settings to start to show results.

Enable Harvest Smart™

Press the Harvest Smart™ button on the arm rest to view the Harvest Smart™ home screen.

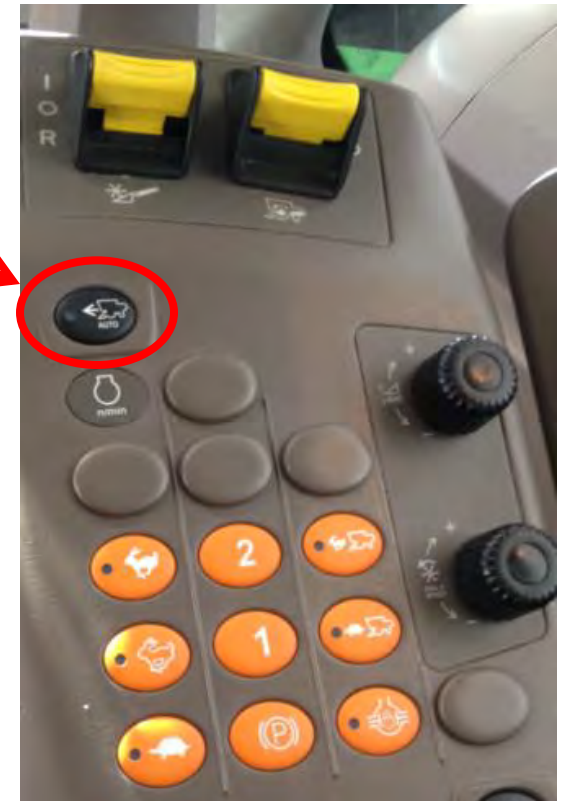
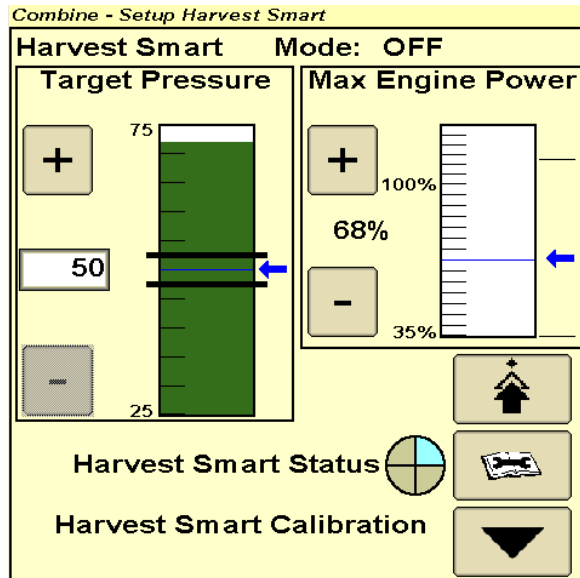

Pressing again toggles between modes.

Harvest Smart™ has three modes Off, Smart, and Capacity.

Notice the indicator light will be on when the system is active.



Smart mode vs. Capacity mode

Harvest Smart Mode: Smart

Smart Mode monitors grain loss levels with VisionTrak™ to ensure the system is at operator designated level.

When loss monitor levels are consistently above or below operator desired levels, the system decreases or increases machine ground speed.

Harvest Smart Mode: Capacity

Capacity Mode Uses engine load and rotor pressure to maintain a constant material flow.

Capacity mode does not adjust the grain loss VisionTrak™ monitor. Use Capacity mode when the machine reacts aggressively to VisionTrak™ crop losses.

Activate Harvest Smart™

The system must first be enabled.

Push button 2 or 3 on the multifunction lever to activate Harvest Smart™.

Then move multi function lever slowly forward to allow the system to increase speed according to crop conditions and max set speed setting.



Operator limits maximum ground speed at all times by pulling back on multi-function lever, for example when header limited conditions are present.

Harvest Smart™ Setup Page

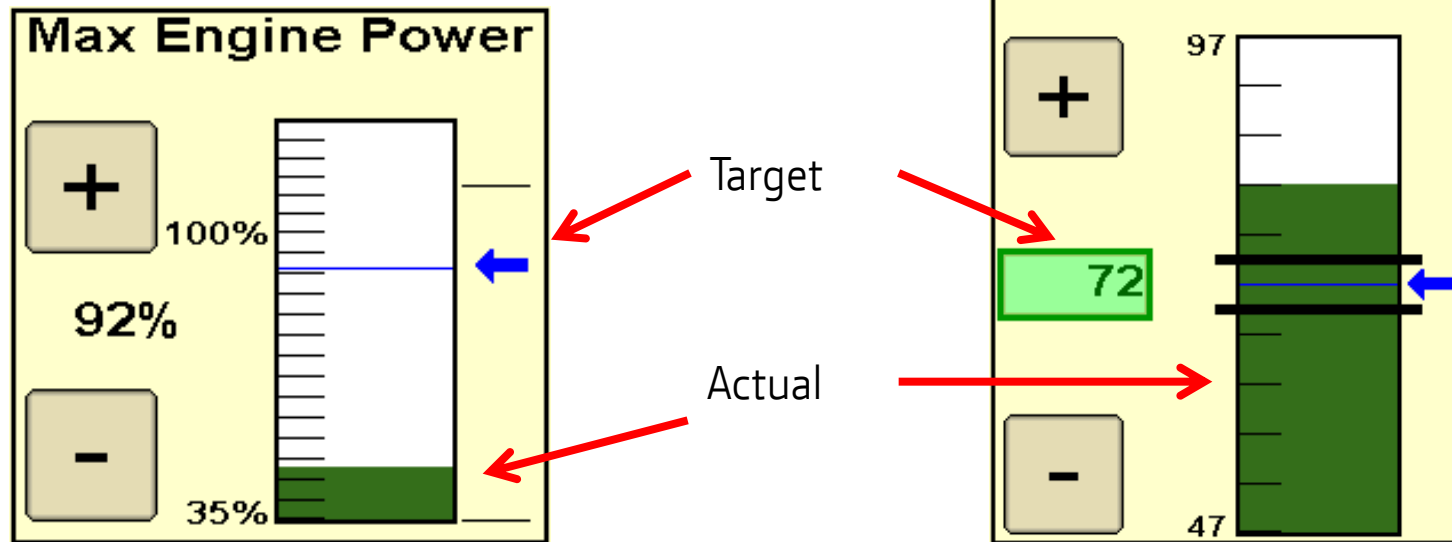

Max Engine Power: This shows actual engine load against the target engine limit. Target can be adjusted by using the plus or minus icons. If slug feeding is a concern, decrease setting for more cushion.

Target Pressure: This shows actual rotor pressure, which is equivalent to the throughput, against the target rotor pressure. Target pressure can be adjusted by using the plus or minus icons.

Harvest Smart™ Setup Page

Advanced Setting icon allows the operator to adjust the max harvest speed and sensitivity of the system. Refer to Operator's Manual for recommended values

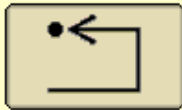

Combine - Setup Harvest Smart

Harvest Smart Mode: Smart	
Max Harvest Speed	3.8 mph
Sensitivity	65
	

The Harvest Smart™ Calibration icon sets material flow and loss level targets for Harvest Smart™. This will also change the previous grain loss calibration factor.



Harvest Smart™ Setup Page

Press the Diagnostic icon for further details on Harvest Smart™ diagnostic status.



When all four quadrants are satisfied the symbol will be green. Harvest Smart™ is now enabled and activated.



Harvest Smart Status



Combine - Setup Harvest Smart		
State	Conditions	Status
	Harvest Smart Installed	Yes
	Manual Mode Deactivated	Capacity
	Separator Engaged Header Engaged Engine at High Idle Road Mode Inactive	Yes Yes Yes Yes
	Activation Button 2 or 3 Pressed	Yes
	Multi-Function Lever Limited Multi-Function Lever Position Harvest Smart Commanded Position	No -53 % 5 %

Multi-function Lever Operation

During unloading multi-function lever response is limited to prevent sudden ground speed changes.

Deactivate the system by pulling back on the multi function lever. When auger is shut off the system will reactivate after pushing the multi-function lever fully forward again.



Notice: Once activation button 1 is pressed the machine will accelerate to the multi-function lever position, returning full control of the multi-function lever to the operator.

This is intended to be a Quick Reference for Harvest Smart™ on S Series Combines. For further and more detailed instructions, Please consult the Operators Manual or contact your John Deere dealer.

ICA

ICA (Interactive Combine Adjustment) will provide you with recommended machine setting changes to improve performance according to your harvesting priorities.

First select (H) the Combine Setup Icon to access ICA.



Now select (I) the ICA Icon.



Select (A) the Combine Setup Icon to begin prioritizing your harvest operation.



ICA

Highlight and prioritize settings by selecting the text and using the arrows.

Once finished Press the accept Icon and return to the ICA home page.

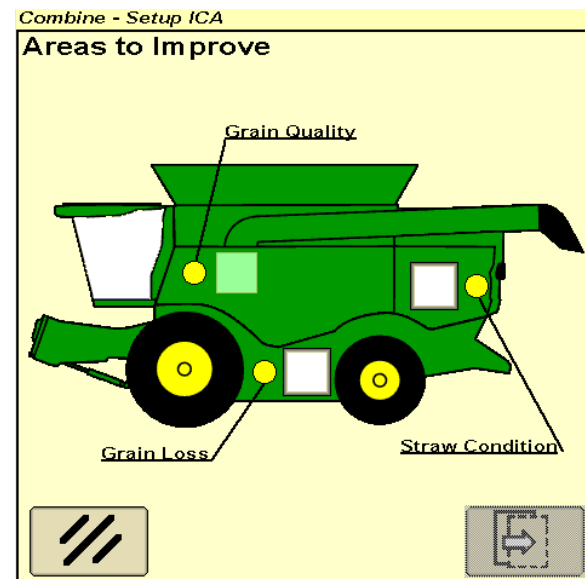
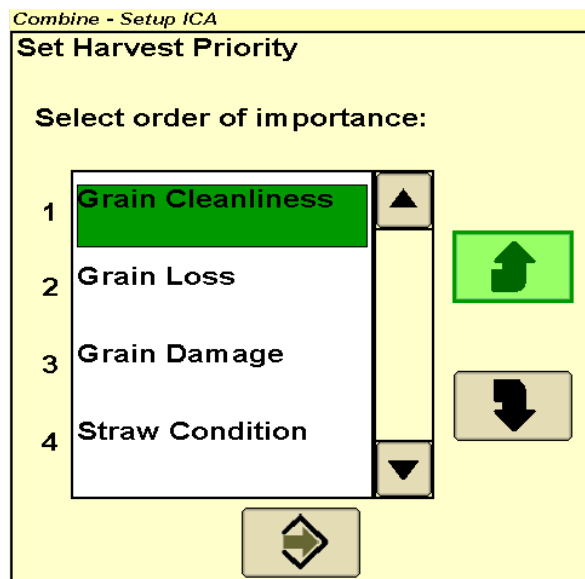

ICA

Next select which area is in need of improvement by checking the box. It is recommended to choose one area at a time but, more than one may be selected.

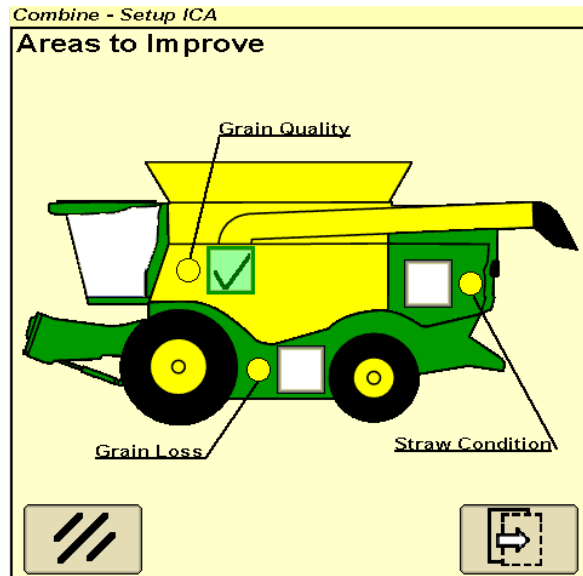

Press the next icon to move on.



Press the back button if there is an additional change or to return to the previous screen.







ICA



Select which subset needs improvement by checking the box.

If more than one area was selected for improvement an additional subset list will show up.

Combine - Setup ICA

Areas to Improve

<input checked="" type="checkbox"/>	Broken Grain	
<input checked="" type="checkbox"/>	Chaff / Husks	
<input checked="" type="checkbox"/>	Straw Pieces / Cobs	
<input type="checkbox"/>	Unthreshed Material	
<input type="checkbox"/>	Excess Tailings	



 



More than one
subset may be
selected.

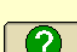

Combine - Setup ICA

Areas to Improve

<input type="checkbox"/>	Separator Loss	
<input checked="" type="checkbox"/>	Shoe Loss	
<input type="checkbox"/>	Unthreshed Loss	

Select the “Question mark” Icon for a description of each subset.























Press the “next” Icon to move forward.

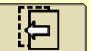

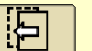
ICA

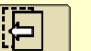
ICA will compile a list of Machine setting recommendations. The next recommendation will be shown above the current recommendation.

Combine - Setup ICA	Combine - Setup ICA	Combine - Setup ICA	Combine - Setup ICA
Next Recommendation Function : Cylinder Speed Direction : Decrease Step : 60 n/min	Next Recommendation Function : Threshing Clearance Direction : Increase Step : 6 mm	Next Recommendation Function : Chaffer Position Direction : Decrease Step : 4 mm	Next Recommendation Function : Ground Speed Direction : Increase Step : 0.3 mph
Current Recommendation Function : Cleaning Fan Speed Direction : Increase Step : 130 n/min	Current Recommendation Function : Cylinder Speed Direction : Decrease Step : 60 n/min	Current Recommendation Function : Threshing Clearance Direction : Increase Step : 6 mm	Current Recommendation Function : Chaffer Position Direction : Decrease Step : 4 mm
  	  	  	  
 	 	 	 

Press the “scroll” icons to view the available machine setting recommendations.



Press the “back” button to return to the previous page. Press the



“abort” icon to Exit ICA.



ICA

Press the “accept” Icon to select the current recommendation, the machine will automatically adjust the setting.



Once selected ICA will prompt “Adjustment being performed” a status symbol will appear at the bottom of the display.

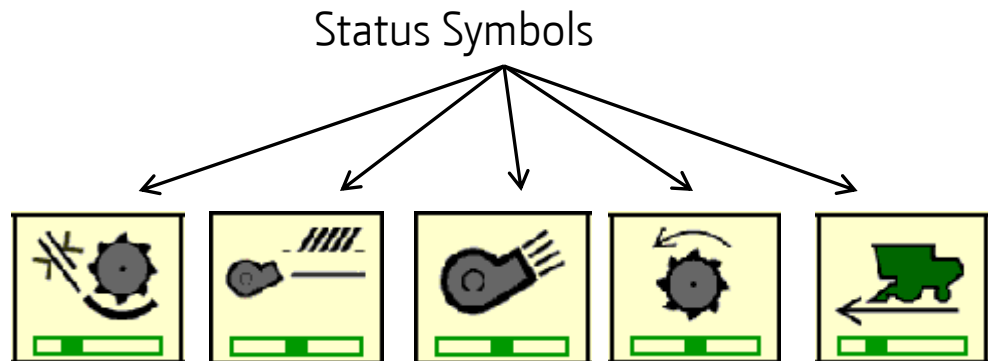
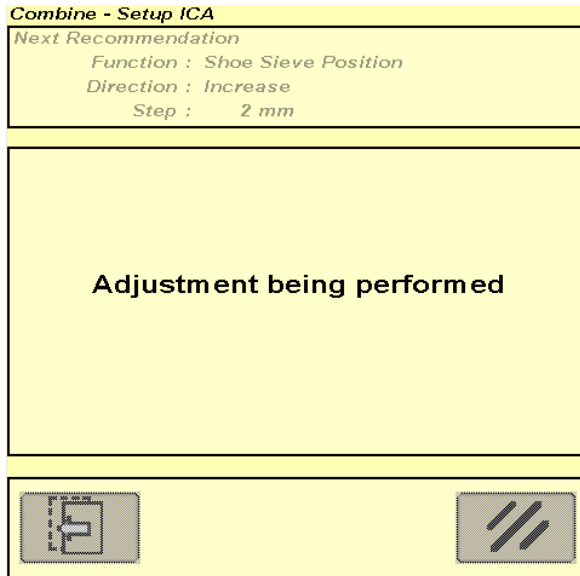

ICA

The ICA icon will flash yellow once the adjustment is complete, select the Icon to “Evaluate the change in performance”.



Combine - Setup ICA

Evaluate the change in performance.

Indicates Previous Value

Indicates Negative Impact

Indicates Positive Impact



Combine - Setup ICA

Evaluate the following areas of improvement.

Broken Grain
Issue Resolved

Chaff / Husks
Issue Resolved

Straw Pieces / Cobs
Issue Resolved

Press next to “Evaluate the following areas of improvement”, select the status of the issue from the drop down box.

Select the “next” Icon to move forward.



ICA

Next determine if any new issues are present as a result of the recent adjustment, select one of the answers listed.

Press “next” to continue.



Combine - Setup ICA



Are any new issues present due to adjustments?

☒ No, continue optimization

☐ Yes, keep setting and report new problem

☐ Yes, undo last adjustment and continue

☐ Yes, undo all adjustments and start over



Combine - Setup ICA

Optimization Complete

If all previous issues were “Resolved” and no New issues were reported the “optimization is complete”. Otherwise, previous steps can be repeated until desired performance level is reached.

ICA

If the system detects a change in machine performance, such as high losses, the ICA icon becomes Red. Select the ICA icon button to launch a new optimization.



This is intended to be a Quick Reference for Interactive Combine Adjust on S Series Combines. For further and more detailed instructions, Please consult the Operators Manual or contact your John Deere dealer.



MyOperations App

Remote Display Access

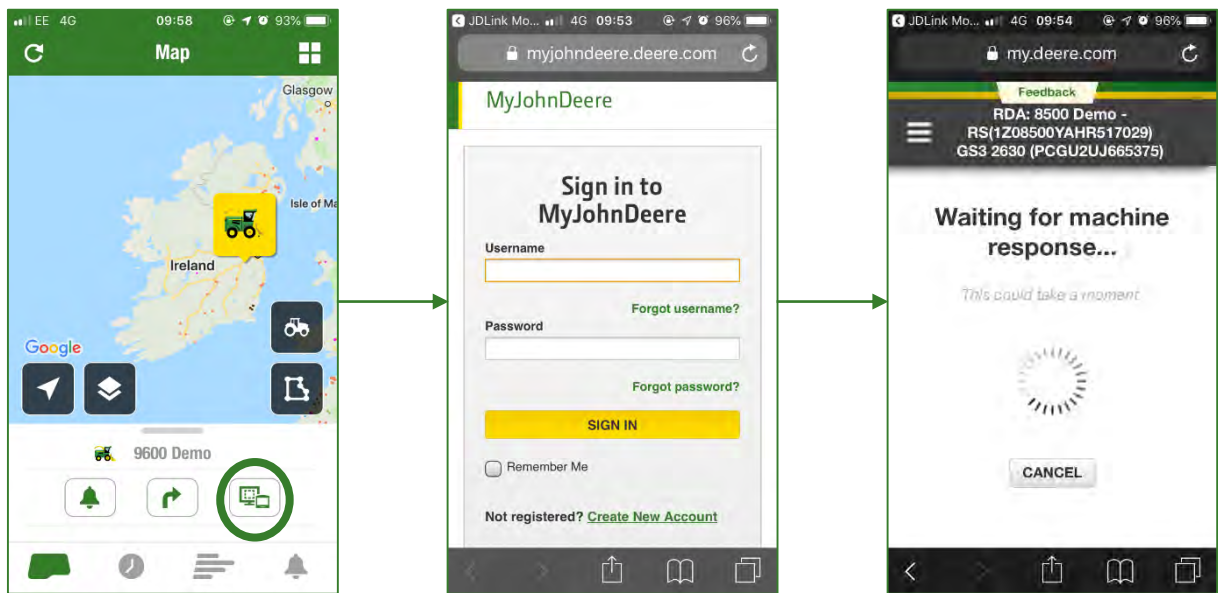

Select your machine and select remote display access to see the display

Notifications

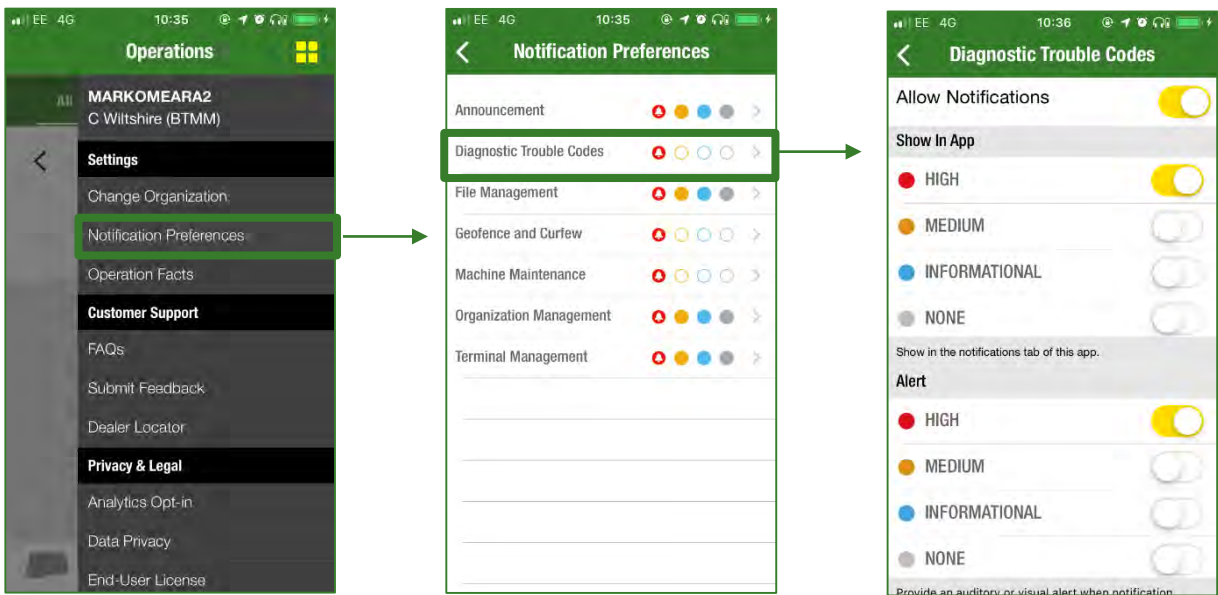

Filter your notifications so you only see what you want





MyOperations App

Operation Overview

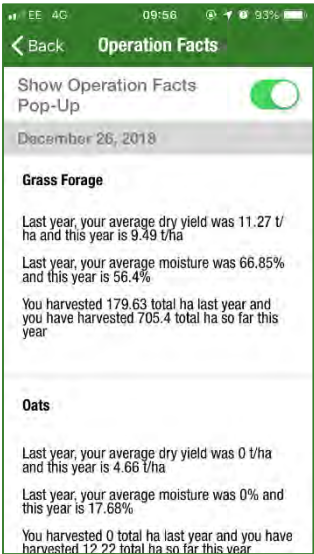
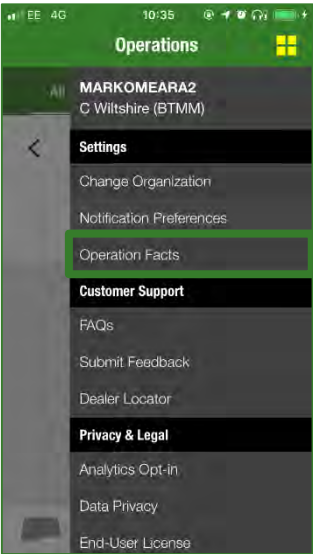

See your harvest summary

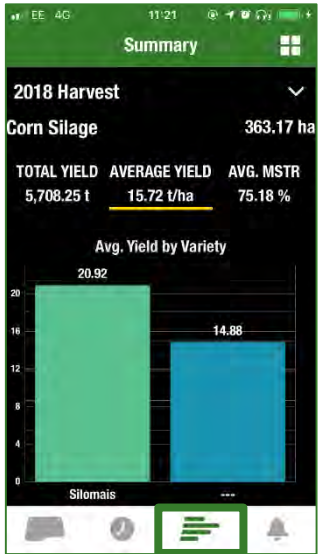

View your harvest data based on crop variety



Select your field to see your data.

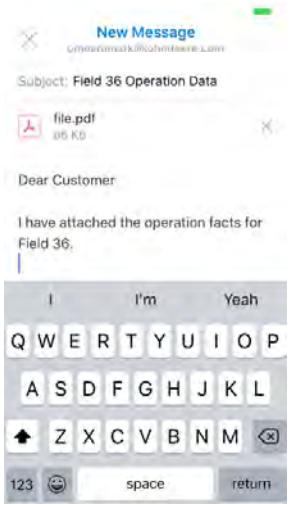

Export your data via a PDF using your preferred method.





JDLink Overview

JDLink™ is John Deere’s telematics system designed to take operations to the next level of productivity and efficiency. Use JDLink™ to remotely locate your fleet, view machine information & diagnostics trouble codes (DTCs), or to get driving directions to a machine when a trip is needed. Leveraging the power of JDLink™ enables data-based decisions that optimize productivity, increase uptime, and boost profits.

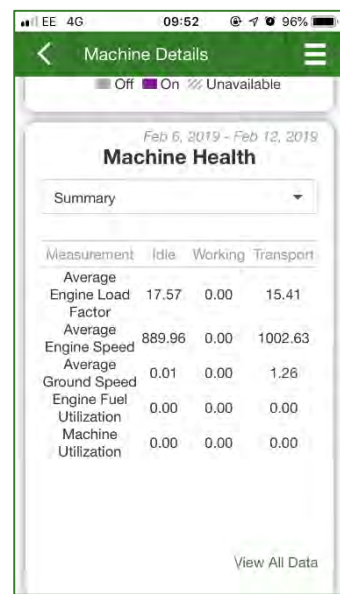
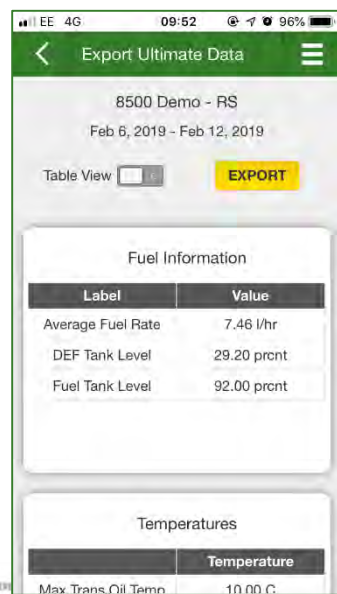
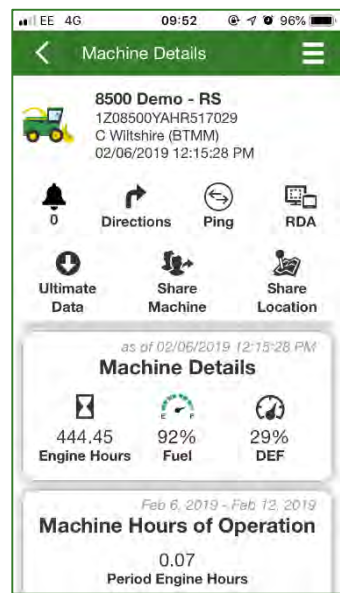



Mobile App

GoHarvest

The GoHarvest application gives S, W and T series combine operators the ability to optimize their 2012 or newer machine as they enter the harvest season. Operators choose the model of combine and type of crop. GoHarvest suggests initial settings for that crop type. GoHarvest also features a notes section and photo functionality to give combine operators a premium experience when setting their machine. Use the Seed Loss Calculator to calculate losses to optimize settings. GoHarvest is also a great guide to use in field for settings changes as conditions differ, and to document changes made to settings during harvest.



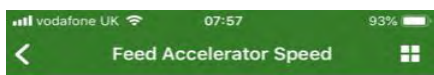

Feed Accelerator Speed
High

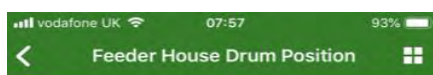

Feeder House Drum Position
Down



Tailings System Concave Position (If Equipped)
Grain

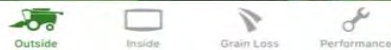

Operator Tip: Returns to be set wide for rape seed.

Wheat

CONFIGURATION	VALUE
Chaffer Clearance (mm)	13 - 18
Concave	Small Wire
Dual Zone Chaffer Clearance (mm)	5 Level 10 Sidehill
Fan Speed (rpm)	900 - 1250
Sieve Clearance (mm)	3 - 8
Threshing Clearance	8 - 16
Threshing Speed (rpm)	750 - 950
Top Cover Transport Vanes (If Equipped)	Standard



Oats

CONFIGURATION	VALUE
Chaffer Clearance (mm)	18 - 22
Concave	Small Wire
Dual Zone Chaffer Clearance (mm)	5 Level 10 Sidehill
Fan Speed (rpm)	750 - 900
Sieve Clearance (mm)	6 - 10
Threshing Clearance	15 - 25
Threshing Speed (rpm)	600 - 900
Top Cover Transport Vanes (If Equipped)	Standard



Rape Seed

CONFIGURATION	VALUE
Chaffer Clearance (mm)	10 - 14
Concave	Small Wire
Dual Zone Chaffer Clearance (mm)	5 Level 10 Sidehill
Fan Speed (rpm)	600 - 900
Sieve Clearance (mm)	2 - 5
Threshing Clearance	15 - 40
Threshing Speed (rpm) ⓘ	350 - 550
Top Cover Transport Vanes (If Equipped)	Standard



Spring Barley

CONFIGURATION	VALUE
Chaffer Clearance (mm)	13 - 18
Concave	Small Wire
Dual Zone Chaffer Clearance (mm)	5 Level 10 Sidehill
Fan Speed (rpm)	850 - 1100
Sieve Clearance (mm)	6 - 9
Threshing Clearance	5 - 22
Threshing Speed (rpm)	700 - 950
Top Cover Transport Vanes (If Equipped)	Standard



Beans

CONFIGURATION	VALUE
Chaffer Clearance (mm)	13-17 (Deep Tooth) 14-18 (General Purpose)
Concave	Round Bar
Dual Zone Chaffer Clearance (mm)	5 Level 10 Sidehill
Fan Speed (rpm)	800 - 1050
Sieve Clearance (mm)	5-9 (Deep Tooth) 6-10 (General Purpose)
Threshing Clearance	15 - 30
Threshing Speed (rpm)	450 - 650
Top Cover Transport Vanes (If Equipped)	Standard





Tailings System Concave Position (If Equipped)
Corn

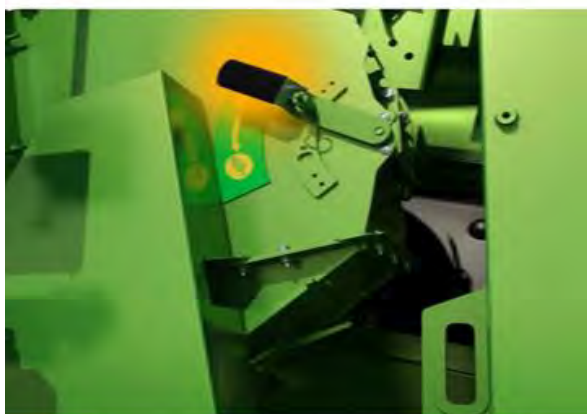

Feed Accelerator Speed
Low



Feeder House Drum Position
Down



Go Harvest App

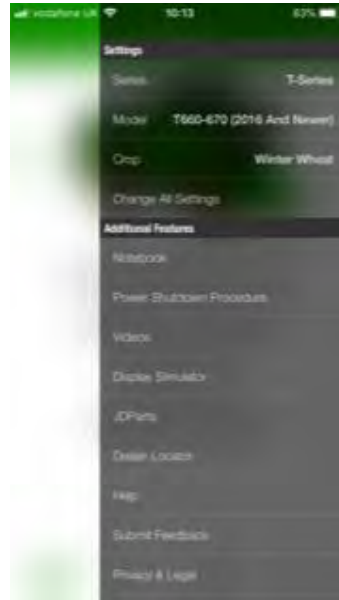
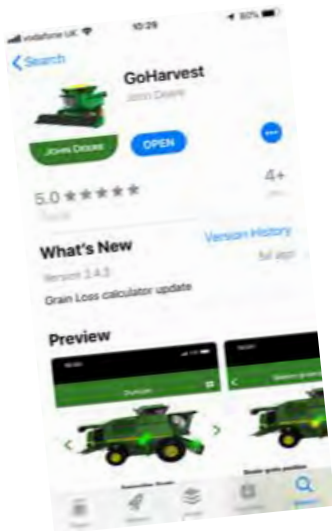

John Deere offer a really useful app, called Go Harvest, download the app to see some of the benefits below, with quick links to the right hand side, for instructional videos, display simulator, and JDParts.

The app also has shortcuts along the bottom for mechanical changes around the machine and in cab crop settings, grain loss calculator and performance optimiser.

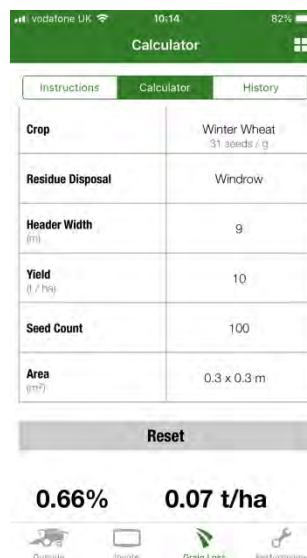

John Deere Combines/Header Offsets

GreenStar 2 Pro - Equipment

Machine

Machine Type: Combine
Machine Model: [dropdown]
Machine Name: [text]
Connection Type: Front Rigid 3-pt
Machine Turn Radius: 6.7 (m)
Turning Sensitivity: 70

Offsets

0.000 (m)
0.00 (m) 0.00 (m)

Change Offsets

* Recording Source: AUTO

Documentation and Coverage: [checkbox]
Enable Monitoring without GPS: [checkbox]

Memory Used: [bar]

Input machine type and name. Enter GPS receiver offsets. Select connection type to your implement and select a Recording Source to use Documentation.

4:12pm

Machine Offsets

A: 0.000 (m)
B: 0.00 (m)
C: 0.00 (m)

Non-Steering Location: [dropdown]
Front Axis: [dropdown]

A: Lateral distance from center-line of machine to GPS receiver
B: In-line distance from non-steering axle to GPS receiver
C: In-line distance from non-steering axle to connection point

Offsets Machine/Combine (m) HM =	W&T (5 walkers) and C-Series w/o HM - w/ HM	W&T (6 walkers) w/o HM - w/ HM	S-Series 690 w/o HM - w/ HM
Hill Master	0,00 1,95 - 1,97 2,04 - 2,05	0,14 * 1,95 - 1,97 2,04 - 2,05	0,00 2,20 - 2,22 2,60 - 2,61

A = Lateral distance from center-line of Machine to GPS Receiver B= In-line distance from non-steering axle to GPS receiver
C= In-line distance from non-steering axle to header attachment

* Receiver/cab shift on left side like on picture

GreenStar 2 Pro - Equipment

Implement

Implement Type: Platform
Implement Model: Platform01
Implement Name: TM-Training01

Physical Width: 9.144 (m)
* Implement Width: 6.1 (m)
Track Spacing: 9.1440 (m)

Offsets

0.00 (m)
0.00 (m) 0.00 (m) 0.00 (m)

Change Offsets

Change Widths

Cut Width Increment: 0.8

Input Implement Type and Name. Enter the implement offsets and widths. If a receiver is connected to the implement, enter the receiver offsets.

4:20pm

Offsets

A: 0.00 (m)
B: 0.00 (m)
C: 0.00 (m)
D: 0.00 (m)

A: In-line distance from connection point to rear of implement
B: In-line distance from front to rear of implement
A+B = Documentation/Swath Control location when in use
C: Lateral distance from connection point to control point of implement
D: In-line distance from connection point to control point of implement

Offsets Implement/Header (m)	600 - Serie
A = In-line distance from connection point (header attachment) to rear of implement	0,00
B = In-line distance from front to rear of implement	1,18
A+B = Documentation location when in use	1,18
C = Lateral distance from connection point (header attachment) to control point of implement	0,00
D = In-line distance from connection point (header attachment) to control point of implement	0,00

NOTE: For 3-point mounted implements, dimension (D) does not need to be entered. NOTE: Change Offsets only accessible if Implement Model & Name completed

Important: all these dimensions may need to be adjusted for fine-tuning performance in the field.

IMPORTANT: Regular and thorough cleaning of machine combined with other routine maintenance procedures listed in the Operator's Manual greatly reduce the risk of fire, chance of costly downtime, and improve machine performance.

Crop material and other debris can accumulate in various areas. Direction of wind, type of crop, and crop moisture content can all impact where and how much crop material and debris can accumulate. Be aware of harvest conditions and adjust your cleaning schedule to ensure proper machine function and to reduce the risk of fire. These areas may require more frequent cleaning, even multiple times per day,

depending on harvest conditions. Inspect and clean these areas as needed throughout the harvest day.

Other areas not covered in this section may also collect crop debris and **MUST** be cleaned periodically for machine function and appearance.

Thoroughly inspect the entire machine on a regular basis throughout the harvest season. Refer to the Machine Cleanout Section of your Operator's Manual for further information.

NOTE: Some shields were removed for photo clarity.

Engine Compartment

- Top Area of Engine and Turbocharger(s) (1)
- Exhaust Manifold and Manifold Shield, Turbo Interstage Tube, Exhaust Gas Recirculation (EGR) Cooler Tube (2)
- Around Engine (3)
- Underneath Engine (4)

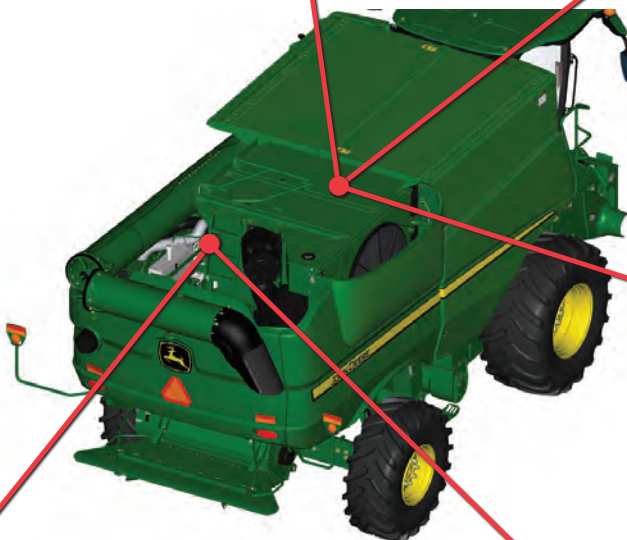
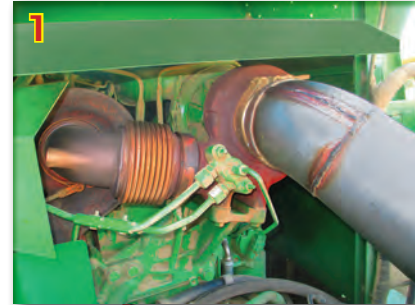

READ SAFETY INFORMATION IN OPERATOR'S MANUAL

Always follow all safety procedures posted on the machine and in the Operator's Manual. Before carrying out any inspection or cleaning, always shut OFF engine, set parking brake and remove key.

Thoroughly clean machine from top to bottom with compressed air. First clean all

areas accessible from engine deck. Start with engine compartment and work outwards and counterclockwise to other areas around engine compartment, floor underneath engine, top rear of rotor and rear deck, including areas around Exhaust Aftertreatment Enclosure (if equipped). Once top areas of machine are clean, proceed to cleaning areas accessible from ground level.

From ground level, clean rear underside of fuel tank area and top of the rear tailboard of the residue disposal system. Exhaust Aftertreatment Enclosure area (if equipped) will also need to be cleaned from ground level. Once the cleaning from ground level is finished, recheck engine compartment for any crop debris that could have blown in from ground level cleaning.



Engine Compartment (cont)

- Top rear of rotor and areas around rotor drive (5)
- Main Engine Gearcase (6)
- Areas around and under Exhaust Aftertreatment Enclosure (7)
- On Top of Fuel Tank (8)



Ground Accessible

- Rear Tailboard and underneath Fuel Tank (9)
- Left Side Walk Area (10)
- Left Side Sidesheet Areas (11)

